

## WHIRLPOOL BRAND COMMERCIAL DRYERS



### FRONT LOCK READY

Factory installed lock blank provides a visual vandalism deterrent.

To further discourage theft, order optional front panel lock assembly (part #358290) for the added security of tying the front and top panels together.

### 1/3 HP MOTOR

1/3 HP motor with overload protection.

### THERMOSTAT

Single operating thermostat for simple accurate temperature control.



### IMPROVED AIRFLOW SYSTEM

Whirlpool® commercial dryers have a new Blower

Housing Wave Insert to increase air velocity up to 10%. This increases efficiency, heating element lifespan, and improves fabric care.\*

\*Results per Whirlpool dryer testing conducted 7/03-8/04

### LARGE CAPACITY METERCASE

Larger coinbox for reduced collections. Accepts coin slides, coin drops and card readers.



### LARGE 7.4 CU. FT. DRUM CAPACITY

The increased capacity allows for large loads

of clothes to tumble and spread, saving you and your customers drying time and expense.

### LARGE LINT FILTER

Pull-out, 84 square inch lint filter.



### 4-WAY VENTING

4-Way venting from left or right side, back or bottom.



### SIDE SWING DOOR

For convenient access, the wide-opening side-swing door can be opened a full 180°.

### RUST PROOF SCREWS

Rust Proof Stainless Steel Torx® control panel screws give your machines added security and service life.



## COMMERCIAL DRYERS

Featuring Mechanical Controls



### CEM2760TQ — 27" Electric Dryer CGM2761TQ — 27" Gas Dryer with Metercase

Machine Accepts the Following Payment Systems (not included):

- Coin Slide
- Retrofit Coin Drop
- Retrofit Card Reader
- OPL Push-to-Start Kit (No Coins Needed)

- Large 7.4 Cu. Ft. Drum Capacity
- Push Button Controls
- 3 Cycles: Regular/Heavy (High Heat), Permanent Press (Medium Heat) and Knits/Delicates (Low Heat)
- 3 Timing Cycles Possible with Included Cams\*
- Large, Removable, Door-Mounted Lint Screen (84 Sq. In.)
- 180° Wide-Opening Side-Swing Door
- Porcelain Top, Powdered Paint Cabinet
- Front-Service Accessibility
- Four-Way, Multi-Vent Options (Back, Bottom and Sides)
- Element Rated at 5600 Watts 240-Volt
- Gas Model Features a 22K BTU Burner
- Motor: 1/3-HP with Built-In Overload Protector; Centrifugal Switch Turns Off Heating Element When Motor Stops
- Easy-to-Follow Console Instructions
- **3 Year Limited Parts Only Warranty\*\***

\*45 Minute Timing Cam Installed, 30 and 60 Minute Cams Included.

\*\*Call 1-800-NO-BELTS for warranty details.

# COMMERCIAL DRYER SPECIFICATIONS

## SINGLE DRYER SPECIFICATIONS

MODEL NUMBER	CEM2760TQ*	CGM2761TQ*
<b>GENERAL INFORMATION</b> Stainless Steel Look Push Button console, white enamel drum, porcelain finish top, powdered paint cabinet, front panel lock blank factory installed, removable indoor lint filter, improved meter case, 4-Way Venting	Metercase Model Accepts the Following Payment Systems: Coin Slide Retrofit Coin Drop Retrofit Card Reader OPL Push-to-Start	Metercase Model Accepts the Following Payment Systems: Coin Slide Retrofit Coin Drop Retrofit Card Reader OPL Push-to-Start
<b>ELECTRICAL REQUIREMENTS</b>	3-Wire Nominal 240/208-Volt, 60 Hz., A.C. Standard 30 Amps Breaker/ Fuse Branch Circuit per Dryer (Subject to Local Codes)	Nominal, 120-Volt, 60 Hz., A.C., Standard 15 Amps Breaker/Fuse Branch Circuit per Dryer (Subject to Local Codes)
<b>MOTOR</b>	1/2-HP Single Speed Motor with Built-In Overload Protector 5.9 Amps Max Rating	1/3 HP Single Speed Motor with Built-In Overload Protector 5.9 Amps Max Rating
<b>HEATER TYPE</b>	<b>ELECTRIC</b>	<b>GAS**</b>
<b>HEATER/BURNER RATING</b> (Add 500 watts approx for motor on all dryer models)	Heater Rated at 5600 watts	22,000 BTU Natural Gas
<b>OPERATIONAL AMPERAGE</b> (Does not include control or gas valve)	Motor—4.0 Amps No load Heater—23.33 Amps @ 240-Volt 27.33 Total	Motor—4.0 Amps No load
<b>DIMENSIONS</b>	43" H*, 27" W, 28.5" D	43" H*, 27" W, 28.5" D
<b>SHIPPING WEIGHT (EST.)</b>	134 Lbs.	135 Lbs.
<b>DRUM VOLUME</b>	7.4 Cu. Ft.	7.4 Cu. Ft.

\* (height at meter case top) \*\*\*(height at dryer top panel)

\*\* Burner orifices are available for manufactured, natural, mixed and LP gas with varying BTU ratings

• LP Conversion Kit: 49572

▲ Power cords on electric models sold separately

Energy information is available online at [www.whirlpoolcommerciallaundry.com/products](http://www.whirlpoolcommerciallaundry.com/products).

## EXHAUST INFORMATION

All dryers require the equivalent of a 4-inch diameter exhaust duct. Rigid metal duct is recommended. Failure to properly exhaust the dryer will result in improper operation.

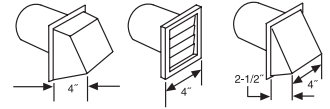

27" & 29" Dryer Venting Requirements

# of 90° Turns	4" Hood	2 1/2" Hood
<b>Maximum Length of 4" Diameter Rigid Metal Duct</b>		
0	64 Ft.	58 Ft.
1	54 Ft.	48 Ft.
2	44 Ft.	38 Ft.
3	35 Ft.	29 Ft.
4	27 Ft.	21 Ft.

# of 90° Turns	4" Hood	2 1/2" Hood
<b>Maximum Length of 4" Diameter Flexible Metal Duct</b>		
0	36 Ft.	28 Ft.
1	31 Ft.	23 Ft.
2	27 Ft.	19 Ft.
3	25 Ft.	17 Ft.
4	23 Ft.	15 Ft.

Dimensions are for planning purposes only. For complete information, see installation instructions packed with product.

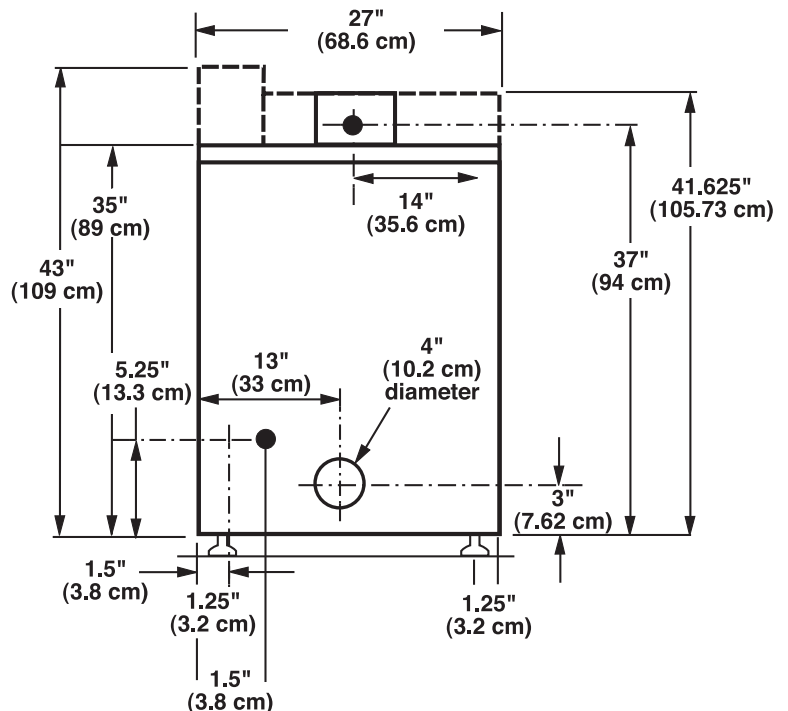
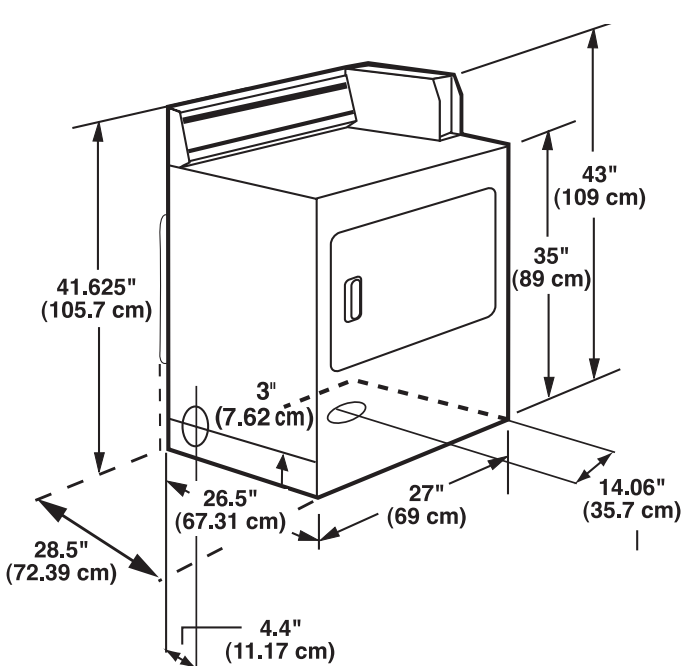

To Locate a Distributor Near You, Please Visit [www.whirlpoolcommerciallaundry.com/distributor](http://www.whirlpoolcommerciallaundry.com/distributor), or call 1-800-N0-BELTS

TORX is a registered Trademark of Textron Industries, Inc.

®Registered trademark/™Trademark of Whirlpool, U.S.A. ©2008 Whirlpool Corporation. All rights reserved.  
Whirlpool Corporation • Benton Harbor, Michigan 49022 U.S.A.

